

Notes:

- This plan is for subdivision consent purposes only and should NOT be used for any other purpose without the permission of Fox & Associates Ltd.
- The aerial imagery is orthophotography provided by Environment Canterbury. Data sourced from canterburymaps.govt.nz "Latest Imagery" layer August 2023 and is used under Creative Commons 3.0 license.
- St James ODP sourced from HDC District Plan.

Scheme Plan Approved
8 Nov 2023
RC # : 220154
By : N. Kirby



www.foxsurvey.co.nz
0800 FOX SURVEY
P.O.Box 895
CHRISTCHURCH

Franco Farms Subdivision, Hanmer Springs

Aerial Overview

Address: 88 Argelins Road, Hanmer Springs		Scale (A1) 1:2000		Job No.
Consent No:		Reduced (A3) 1:4,000		5339D
RC 220154 - 220155		Designed		Sheet No.
Project Phase:		Drawn		2 of 28
Consent Application		Checked		Rev.
		12 SEPT 2022		C

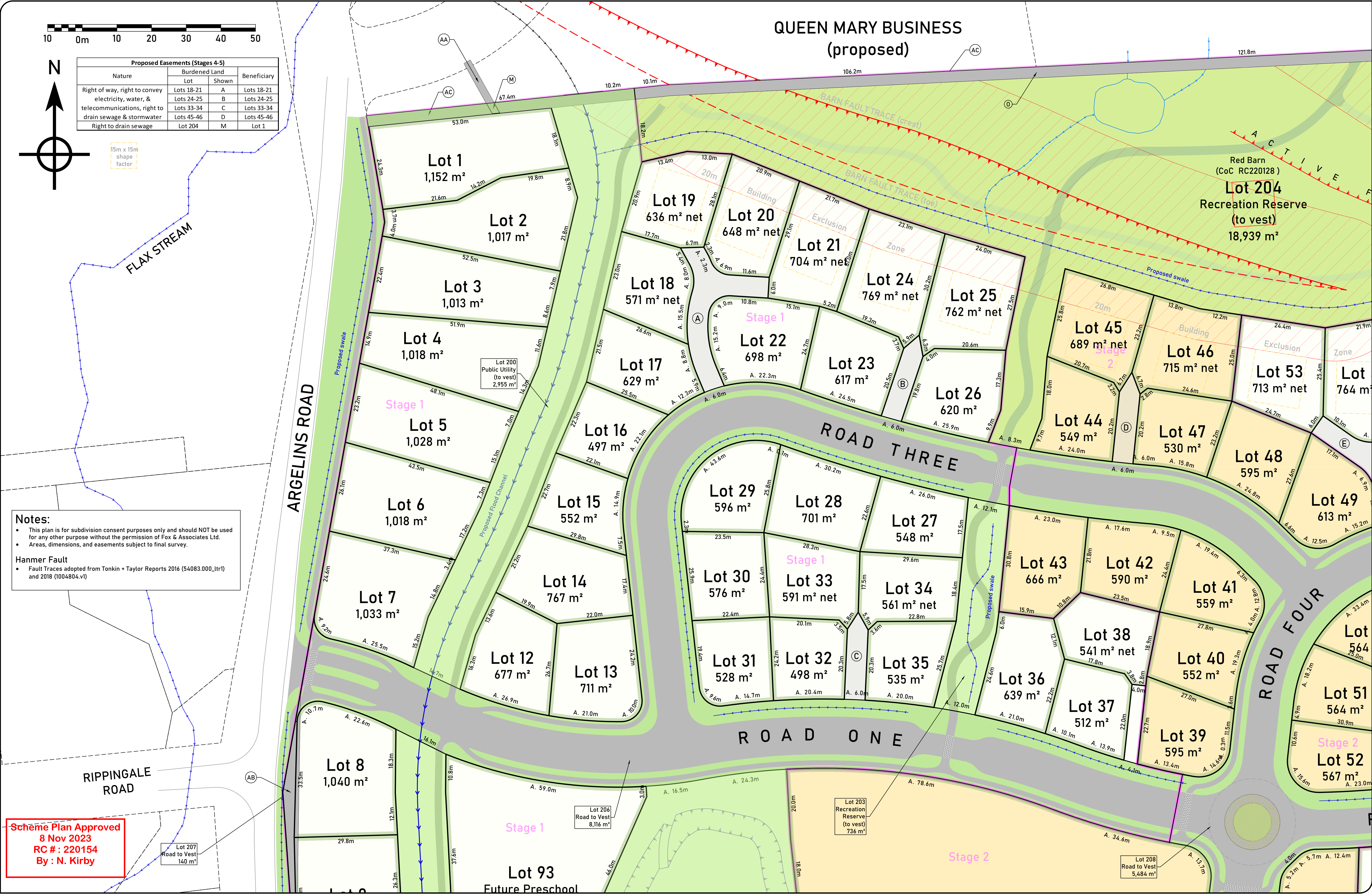

Notes:

- This plan is for subdivision consent purposes only and should NOT be used for any other purpose without the permission of Fox & Associates Ltd.
- Areas, dimensions, and easements subject to final survey.

Hanmer Fault

- Fault Traces adopted from Tonkin + Taylor Reports 2016 (54083.000_1tr1) and 2018 (1004804.v1)

Scheme Plan Approved
8 Nov 2023
RC #: 220154
By: N. Kirby



creating legacies with land

www.foxsurvey.co.nz

0800 FOX SURVEY

P.O.Box 895

CHRISTCHURCH

Franco Farms Subdivision, Hanmer Springs

Lot Layout (1 of 3)

Address:	88 Argelins Road, Hanmer Springs	Consent No:	RC 220154 - 220155	Project Phase:	Consent Application	G	----	Scale (A1)	1:500	Job No.	5339D
						F	----	Reduced (A3)	1:1,000	Sheet No.	3 of 28
						E	----	Designed	CAF	Rev.	D
						D	Staging adjustments for pedestrian access	TPC	27 SEP 2023		
						C	Road widths / Attenuation basin outlets / Services layout	TPC	12 AUG 2023		
						B	Treatment Swales	TPC	24 MAY 2023		
						A	Updates/new sheets per HDC Request for Information	CAF	2 NOV 2022		
						No.	Revision	Appd	Date	Date	12 SEPT 2022

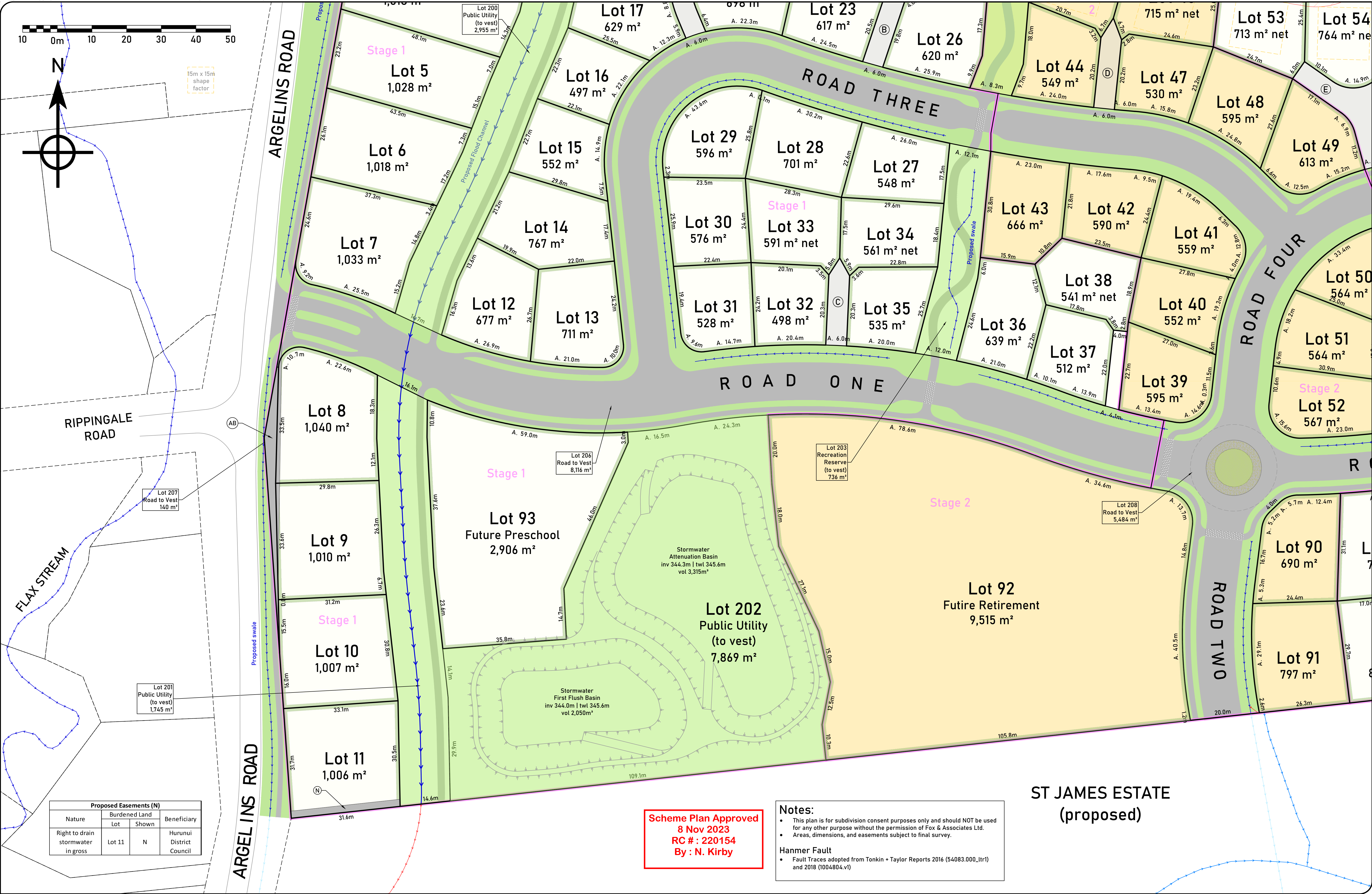

Scheme Plan Approved
8 Nov 2023
RC # : 220154
By : N. Kirby

Notes:

- This plan is for subdivision consent purposes only and should NOT be used for any other purpose without the permission of Fox & Associates Ltd.
- Areas, dimensions, and easements subject to final survey.

Hanmer Fault

- Fault Traces adopted from Tonkin + Taylor Reports 2016 (54083.000_ttr1) and 2018 (1004804.v1)

ST JAMES ESTATE
(proposed)

